For *in vitro* diagnostic use
For prescription use only

INDICAID[®]
FebriDx[®]

INSTRUCTIONS FOR USE

FebriDx Bacterial / Non-Bacterial Assay

**Please read this package insert carefully prior to use
and strictly follow the instructions.**

The FebriDx Bacterial/Non-Bacterial Assay is intended to be used at sites operating with a CLIA Certificate of Waiver. Laboratories with a Certificate of Waiver must follow the manufacturer's instructions for performing the FebriDx test. Any modification by the user(s) to the manufacturer's test procedures will result in the test no longer meeting the requirements for waived classification Certificate of Waiver.

CLIA WAIVED

A Certificate of Waiver is required to perform this test in a CLIA Waived environment. To obtain CLIA waiver information and a Certificate of Waiver, contact your state health department. Additional information is available at www.cms.hhs.gov/CLIA.

INTENDED USE

The FebriDx Bacterial/Non-Bacterial Assay is a qualitative visually read rapid immunoassay for the detection of human host response proteins, Myxovirus resistance protein A (MxA) and C-reactive protein (CRP) directly from fingerstick blood. FebriDx is indicated for use in patients aged 12-64 for evaluation of acute respiratory infection who have had symptoms for less than 7 days and within 3 days of fever onset.

FebriDx test results are intended to be used in conjunction with other clinical and diagnostic findings as an aid in the diagnosis of bacterial acute respiratory infection and differentiation from non-bacterial etiology. The assessment of whether a bacterial infection is present should always be based on consideration of all available information, and not based solely on the FebriDx test results. FebriDx test results are not intended to identify a specific pathogen or the severity of infection.

SUMMARY & EXPLANATION

Acute respiratory infections (ARIs) including sinusitis, pharyngitis, bronchitis, and influenza are the most common reason for physician office visits and antibiotic prescriptions worldwide.¹⁻³ The significant overlap in symptoms and signs makes it challenging for physicians to differentiate bacterial infections from non-bacterial etiology to identify which patients require antibiotic therapy. The vast majority of ARIs are caused by non-bacterial etiology, for which antibiotics provide no clinical benefit, however 30-80% receive antibiotics. The over prescription of antibiotics for ARI is a leading contributor to the global antimicrobial resistance (AMR) crisis which currently causes 700K deaths annually.⁴ FebriDx utilizes dual biomarker technology to deliver high sensitivity and specificity to differentiate a bacterial infection from non-bacterial etiology.⁵

BIOMARKERS

MxA (Myxovirus resistance protein A)

MxA is an innate host response biomarker that elevates in the presence of acute viral infection but is not specific to a particular type of virus. MxA has a low basal concentration of less than 15 ng/mL, a fast induction time of 1-2 hours, and a long half-life of 2.3 days.⁶ Numerous clinical studies demonstrate that MxA protein expression in peripheral blood has been shown to be a sensitive and specific marker for viral infection.⁷⁻¹⁰ MxA is specific for viral infection only and is not elevated in the presence of a bacterial infection.^{7,8}

CRP (C-reactive protein)

CRP is a nonspecific, acute-phase protein that is upregulated during the presence of acute inflammation, including response to infection. CRP is predominately produced by the liver in response to inflammatory cytokines such as IL-6 and assists in pathogen recognition and phagocytosis by macrophages.¹¹ Infection is a potent stimulus of CRP elevation, which occurs within 4-6 hours of infection, doubles every 8 hours and peaks after 36 hours.¹² At low levels CRP is sensitive but non-specific for bacterial infection.¹³

Multiplexed Pattern of Results

Neither MxA nor CRP alone is sensitive or specific enough to differentiate bacterial infection from non-bacterial etiology in symptomatic patients being evaluated for acute respiratory infection.^{7,13-15} However, when both host response biomarkers are used together in the FebriDx test, bacterial infection can be differentiated from non-bacterial etiologies.^{5,16}

PRINCIPLES OF THE TEST

Myxovirus resistance protein A (MxA) and C-reactive protein (CRP) are non-microbial proteins produced by the innate host response (e.g., interferons, interleukins, and the Complement System) in response to infection. The FebriDx test includes a built-in sample collection and transfer tube and detects the presence of MxA and CRP in fingerstick blood specimens using lateral flow technology. A sample of the fingerstick blood is added to the lateral flow test device; followed by a running buffer that provides sufficient volume to activate the test. The running buffer contains leukocyte membrane lysing agents that release intracellular MxA to allow subsequent detection. The first pad in the device filters out the cellular material as well as intact red-blood cells. The filtered sample then contacts a pad that contains the reagents to adjust pH and prevent non-specific binding. Prior to reaching the test strip, free MxA and CRP migrate through a dried formulation of latex beads that have been further conjugated to antibodies specific for binding a particular analyte (MxA or CRP). As the Analyte-Antibody-Bead complex continues to migrate across a porous nitrocellulose membrane, it can interact with one of three capture antibodies that are immobilized on the surface at distinct line positions, including the control line to verify that the device flowed properly. A black line present in the result window indicates a positive result (bacterial) and a red line in the result window or the absence of a line in the result window indicates a non-bacterial etiology, i.e., negative for bacterial infection. FebriDx simultaneously detects MxA at the medical decision point of approximately 40 ng/mL and CRP of approximately 20 mg/L serum equivalent.

MATERIALS PROVIDED

- 25 Single Use Test Devices
- 1 Package Insert
- 1 Quick Reference Instruction (QRI)

YOU WILL NEED THESE ITEMS

- Timer
- Alcohol
- Gloves
- Gauze
- Bandage

WARNINGS AND PRECAUTIONS

1. For *in vitro* diagnostic use.
2. Do not remove the FebriDx test from the foil pouch until ready to use. If the foil pouch is damaged, do not use the test.
3. Do not use the FebriDx test past the expiration date.
4. Use standard precautions for collecting and handling a blood sample. Proper handling and disposal methods should be established according to local, state, and federal regulations.
5. All specimens should be considered potentially hazardous and handled in the same manner as an infectious agent.
6. Wash hands before and after performing the test and wear disposable gloves while handling specimens. After testing, remove gloves, clean hands, and wear a new pair of clean gloves before testing each patient.
7. The protective cap on the lancet is a single sterile barrier system. Do not use the lancet if the protective tab has been previously removed from the device.
8. The FebriDx test is a single-use item with no reusable components. Do not use on more than one patient. The test is not intended for more than one use.
9. The FebriDx test is designed to proceed in sequential order and locking mechanisms exist to prevent skipping the prior step.
10. Incomplete filling of the blood collection tube could lead to erroneous test results.
11. Interpretation of FebriDx test results involves visual assessment of colored result lines. Users with color-impaired vision should not interpret the test.
12. A brightly lit environment is recommended for interpreting the test results.

STORAGE AND STABILITY

Store the FebriDx tests unopened at a temperature between 39 - 77°F (4 - 25°C). Tests are individually packaged in sealed pouches that make them impervious to humidity differences during transport and storage. As such, unopened FebriDx tests are stable until the expiration date printed on their packaging if stored at the listed temperatures.

OPERATING HUMIDITY AND ALTITUDE

The FebriDx test performed acceptably when tested in the following environments:

- Relative humidity between 5 - 85%
- Altitudes between 0 - 2000 meters

TEST COMPONENTS

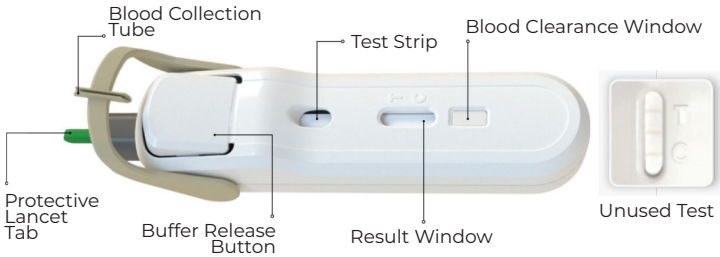

Instructional Video

Access via QR or link



<https://www.youtube.com/@FebriDxInstructionalVideo>

TEST PROCEDURE

Wash hands and put on gloves before testing. Users with color-impaired vision should not interpret the test.

Read the External Control procedure and complete test procedure prior to performing the FebriDx test.

CLIA complexity Waived for fingerstick blood. Follow all steps in order.

1 REMOVE DEVICE & CHECK EXPIRY

Check expiry date

Tear open foil pouch and remove device.

2 MASSAGE FINGER & CLEAN

Select finger and massage from base to tip to increase blood flow.

Cleanse the finger and wipe dry with fresh dry gauze.

3 PREPARE LANCET

Twist Protective Lancet Tab **90 degrees** and pull to remove.

4 LANCE FINGER & WIPE AWAY BLOOD

Firmly press the lancet against the finger to puncture the skin.

Wipe away first drop of blood with clean new gauze.

5 MASSAGE FINGER

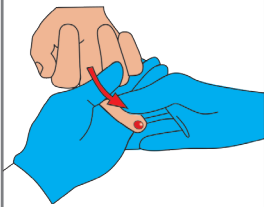

Massage entire finger from base to tip to obtain a large drop of blood that hangs from the finger.

6 COLLECT BLOOD

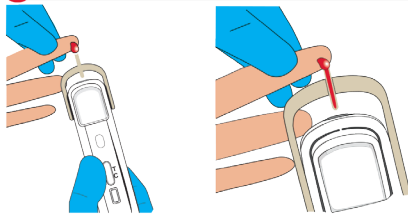

Fill the Blood Collection Tube **completely** with blood. Ensure it only touches the hanging drop of blood and not the finger.

7 VERIFY TUBE IS FULL

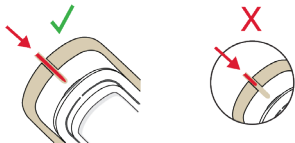

If the Blood Collection Tube is not full, massage the entire finger to obtain more fingerstick blood. If still not full, **discard test. Repeat testing with a new device and finger.**

Warning: Incomplete filling of the Blood Collection Tube could lead to erroneous test results.

8 TRANSFER BLOOD TO TEST STRIP

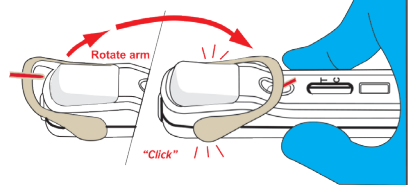

Once the Blood Collection Tube is **completely full**, lay the test on a flat surface. Rotate the Blood Collection Tube to touch the Test Strip.

9 VERIFY BLOOD TRANSFER TO TEST STRIP

Make sure the blood has transferred to the Test Strip.

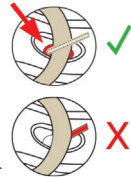
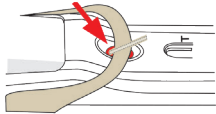

If the blood does not immediately transfer to the Test Strip,

1. Push the Blood Collection Tube down to make sure it is touching the Test Strip.
2. If the blood still has not transferred, immediately reverse the Blood Collection Tube back to its original position and repeat steps 5-8 within two (2) minutes.
3. If the step above is unsuccessful, **discard test. Repeat testing with a new device and finger.**

10a DELIVER BUFFER

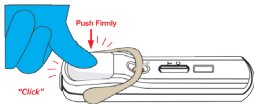

After blood completely transfers, firmly push the Buffer Release Button until it clicks to deliver the buffer.

Make sure Buffer Release Button is completely pushed down.

10b CHECK BLOOD IS FLOWING ACROSS THE RESULTS WINDOW

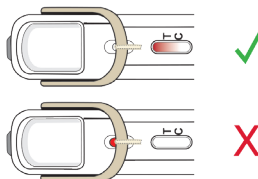

If the blood is not visible in the Result Window within 30 seconds press the Buffer Release Button again until clicking is audible.

If blood is still not visible after pressing the buffer release button again, **discard test. Repeat testing with a new device and finger.**

TEST RESULTS

11 VERIFY TEST IS READY FOR INTERPRETATION

1. **Result Window** must be **clear** of blood.



Result Window

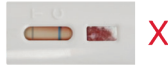

If Result Window **is not clear** after waiting up to 30 minutes, **discard test. Repeat testing with a new device and finger.**

2. **Blood Clearance Window** must contain **pink/red**.



Blood Clearance Window



If Blood Clearance Window **does not contain pink/red** after waiting up to 30 minutes, **discard test. Repeat testing with a new device and finger.**

3. Do not read results **after 1 hour** or before ten minutes.

Reading results before the blood has cleared the Result Window or without blood in the Blood Clearance Window may lead to erroneous test results.

**Test lines depicted are shown as an example.*

TEST INTERPRETATION

Faint or incomplete test lines may still be **interpreted as present**.

12a CHECK FOR VALID TEST



CRP MxA CTL

- **Blue** control (CTL) line present = **Valid Test**
- Valid test result is ready for interpretation



CRP MxA CTL

- No **blue** control (CTL) line = **Invalid Test**
- **Discard test. Repeat testing with a new device and finger.**

12b CHECK FOR BACTERIAL INFECTION



CRP MxA CTL

- Result is **BACTERIAL INFECTION** if:
- **Grey/black** line (CRP) + **blue** control (CTL) line

12c CHECK FOR NON-BACTERIAL ETIOLOGY



CRP MxA CTL

- Result is **NON-BACTERIAL ETIOLOGY** if:
- No test line + **blue** control (CTL) line only, OR



CRP MxA CTL

- **Red** line (MxA) + **blue** control (CTL) line, OR



CRP MxA CTL

- **Grey/black** line (CRP) + **Red** line (MxA) + **blue** control (CTL) line

QUALITY CONTROL

Procedural Control

The FebriDx test has built-in procedural controls represented by a blue control line. For daily quality control, the manufacturer recommends documenting the procedural controls for the first sample tested each day.

External Controls

External controls should be used to demonstrate that the reagents and assay perform properly. External controls (one positive and one negative) are not supplied with the FebriDx test kit (i.e., box of 25 devices). External controls should be used, consistent with good laboratory practices, to verify test performance. Please contact Phase Diagnostics at 657-233-5880 (9:00a.m. to 5:00p.m. CST M-F) to order external controls.

LIMITATIONS

1. The FebriDx test should be used within three (3) days from onset of a fever and less than seven (7) days of new respiratory symptoms.
2. The clinical study was not adequately powered to demonstrate performance among different age groups. Clinical performance has not been established in pediatric patients younger than 12 years old or in elderly patients above 64 years old. The FebriDx test should not be used in these patient populations.
3. The clinical study was not adequately powered to evaluate performance differences in specific races and ethnicities; therefore, results should be interpreted in conjunction with clinical assessments and other diagnostic findings.
4. The FebriDx test is used in conjunction with clinical assessments and other laboratory findings as an aid to diagnose bacterial infection in patients presenting with symptoms of an acute respiratory infection. The assessment of whether a bacterial infection is present should always be based on consideration of all available information, and not based solely on the FebriDx test results.
5. Predictive values of the FebriDx test depend on the likelihood ratios and the prevalence of disease.
6. Fresh capillary blood (fingerstick) must be used on the FebriDx test. Venous blood, serum and/or plasma cannot be used.
7. The blood collection tube must be filled completely and transferred to the test strip for the test to run properly. An erroneous result may occur if an insufficient blood sample is applied to the test.
8. Reading results before the blood clears the Result Window or after 1 hour may produce erroneous results.
9. The internal procedural control confirms the liquid buffer has been delivered to the test strip. Blood must also be present in the blood clearance window before interpretation.
10. Clinical performance has not been established in the following populations:
 - Patients who are immunosuppressed or those receiving immunosuppressive or chemotherapeutic drugs
 - Patients receiving anti-infective drugs
 - Patients receiving interferon therapy
 - Patients receiving live viral immunization within the last 30 days
 - Patients with chronic symptoms or fevers lasting more than 7 days
 - Patients without symptoms of acute respiratory infection
11. Interference testing indicated Rheumatoid Factor may contribute to false negative and false positive results at levels above 50 IU/mL.
12. The FebriDx test is not for home or self-testing.

CLINICAL PERFORMANCE CHARACTERISTICS

Study I: Clinical Sensitivity and Specificity

A well-controlled, prospective, multi-center blinded clinical trial was conducted in the United States (U.S.) to evaluate the clinical performance of FebriDx in patients with Acute Respiratory Infection (ARI) as well as healthy controls. The study was conducted at 20 point-of-care (POC) testing sites that were representative of the intended user and setting. Patients who presented to urgent care or emergency care settings for evaluation of acute respiratory infection (ARI) within 7 days of symptoms with symptoms for less than 7 days and within 3 days of fever onset were screened for eligibility between October 2019-April 2021. ARI Subjects were followed at study day 7 to identify participants who were admitted to the hospital for any reason. FebriDx was compared to a composite Clinical Reference Algorithm that incorporated pathogen detection testing (e.g., bacterial culture, multiplex PCR) as well as measures of host immune response. Physician adjudicators made a final qualitative diagnosis after review of all clinical and laboratory testing data.

Study Demographics

Participants with symptoms for acute respiratory infection and a recent fever, were eligible for enrollment in the ARI cohort and participants without signs/symptoms of acute respiratory infection were eligible for enrollment in the asymptomatic control cohort. Demographics are summarized in the following table.

| Characteristics | Asymptomatic Controls | ARI | Withdrawal After Consent | Overall |
|------------------|-----------------------|-----------------|--------------------------|-----------------|
| Sex | | | | |
| Female | 55.3% (94/170) | 55.8% (290/520) | 58.8% (10/17) | 55.7% (394/708) |
| Male | 44.7% (76/170) | 44.2% (230/520) | 41.2% (7/17) | 44.3% (313/707) |
| Age | | | | |
| N | 170 | 520 | 18 | 708 |
| Mean ± SD | 43.5 ± 24.4 | 35.2 ± 17.7 | 31.1 ± 17.7 | 37.1 ± 19.8 |
| Median | 38.0 | 32.0 | 28.5 | 33.0 |
| (IQR) | (19.0, 69.0) | (23.0, 48.0) | (24.0, 48.0) | (22.0, 50.0) |
| Min, Max | 3, 87 | 1, 95 | 2, 66 | 1, 95 |
| Age Group | | | | |
| 1-21 years | 31.2% (53/170) | 20.8% (108/520) | 22.2% (4/18) | 23.3% (165/708) |
| 22-64 years | 31.8% (54/170) | 71.7% (373/520) | 72.2% (13/18) | 62.1% (440/708) |
| 65+ years | 37.1% (63/170) | 7.5% (39/520) | 5.6% (1/18) | 14.5% (103/708) |
| Race | | | | |
| American Indian | 0 | 0.4% (2/520) | 0 | 0.3% (2/708) |
| Asian | 1.2% (2/170) | 2.7% (14/520) | 0 | 2.3% (16/708) |

| | | | | |
|--------------------|-----------------|-----------------|---------------|-----------------|
| Black | 17.1% (29/170) | 21.2% (110/520) | 33.3% (6/18) | 20.5% (145/708) |
| Other | 2.4% (4/170) | 7.1% (37/520) | 11.1% (2/18) | 6.1% (43/708) |
| Pacific Islander | 0 | 0.2% (1/520) | 0 | 0.1% (1/708) |
| Unknown | 0 | 0 | 5.6% (1/18) | 0.1% (1/708) |
| White | 79.4% (135/170) | 68.5% (356/520) | 50.0% (9/18) | 70.6% (500/708) |
| Ethnicity | | | | |
| Hispanic | 12.4% (21/170) | 18.7% (97/520) | 5.6% (1/18) | 16.8% (119/708) |
| Not Hispanic | 87.6% (149/170) | 80.6% (419/520) | 88.9% (16/18) | 82.5% (584/708) |
| Declined to answer | 0 | 0.8% (4/520) | 5.6% (1/18) | 0.7% (5/708) |

Asymptomatic Controls

Of the total enrolled asymptomatic controls, FebriDx detected a bacterial infection in 3 cases where the adjudicated clinical reference algorithm classified the case as non-bacterial (NPA 98.1% (157/160), 95% CI (94.6%-99.4%)).

Acute Respiratory Infection (ARI) Cohort

The study included 520 symptomatic participants with suspected acute respiratory infection who met inclusion and did not meet exclusion criteria. The cohort included male and female participants from each age group (pediatric, adult, elderly) with diverse ethnic backgrounds that were comparable to the 2020 U.S Census Bureau released demographic analysis.

Of the total enrolled participants with acute respiratory infection, 14.0% (73/520) were classified as having bacterial infection and 81.3% (423/520) were classified as having non-bacterial etiology by the comparator. There were no deaths, adverse events or unanticipated device effects that occurred during the study. FebriDx performance characteristics for bacterial infection are summarized in the following table:

| Characteristic | Estimate | 95% CI |
|----------------|-----------------|---------------|
| PPA | 93.2% (68/73) | 84.9% - 97.0% |
| NPA | 88.4% (374/423) | 85.0% - 91.1% |
| PPV | 58.1% (68/117) | 49.1% - 66.7% |
| NPV | 98.7% (374/379) | 96.9% - 99.4% |
| LR+ | 8.0 | 6.1 - 10.5 |
| LR- | 0.08 | 0.03 - 0.2 |

Positive Percent Agreement (PPA), Negative Percent Agreement (NPA), Positive Predictive Value (PPV), Negative Predictive Value (NPV), Likelihood Ratio (LR), Confidence Interval (CI)

FebriDx performance was analyzed for different age groups (1-21 years, 22-64 years, 65+ years). A Fisher's exact test was performed to evaluate the potential differences in age groups. The analysis showed there are no significant differences between the age groups for PPA. The DISRUPT study was not adequately powered to evaluate differences in performance among different age or demographic groups.

| Characteristic | Estimate | 95% CI |
|--------------------|-----------------|---------------|
| 1-21 years | | |
| PPA | 100.0% (13/13) | 77.2%, 100.0% |
| NPA | 95.7% (88/92) | 89.3%, 98.3% |
| LR+ | 23.0 | 8.8, 60.0 |
| LR- | 0.0 | NA |
| 22-64 years | | |
| PPA | 92.3% (48/52) | 81.8%, 97.0% |
| NPA | 86.7% (260/300) | 82.4%, 90.1% |
| LR+ | 6.9 | 5.1, 9.3 |
| LR- | 0.1 | 0.03, 0.2 |
| 65+ years | | |
| PPA | 87.5% (7/8) | 52.9%, 97.8% |
| NPA | 83.9% (26/31) | 67.4%, 92.9% |
| LR+ | 5.4 | 2.3, 12.6 |
| LR- | 0.1 | 0.02, 0.9 |

Positive Percent Agreement (PPA), Negative Percent Agreement (NPA), Positive Predictive Value (PPV), Negative Predictive Value (NPV), Likelihood Ratio (LR), Confidence Interval (CI)

Study II: Method Comparison Study

A prospective method comparison study that compared the FebriDx test between trained and untrained operators was conducted at 9 CLIA waived sites that were geographically distributed across the United States. A total of 16 untrained operators, representative of CLIA waived users, participated in the study.

Paired fingerstick samples were collected by untrained and trained operators from the same study subject. The participating operators conducted the test by following the Quick Reference Instructions (QRI). The untrained operators had no formal training or experience with CLIA high or moderate complexity testing and did not receive any training on the use of the FebriDx test.

A total of 610 subjects were initially enrolled, of which 595 met the inclusion criteria. Study subjects were excluded from the data analysis for the following reasons: age over 64 years (N=9), fever greater than 3 days (N=2), not having a paired sample (N=2), the same trained operator conducting enriched enrollment (N=2), which left 595 paired samples for analysis. The average age among study subjects was 41 years, with a range between 12 to 64 years of age.

Results exceeded pre-defined success criteria and showed equivalent performance between trained and untrained users. There were no deaths, adverse events or adverse device effects reported during the study.

| | | FebriDx Test Result (Trained Operator) | | |
|--|---------------|--|---------------|-------|
| | | Bacterial | Non-Bacterial | Total |
| FebriDx Test Result (Untrained Operator) | Bacterial | 106 | 8 | 114 |
| | Non-Bacterial | 1 | 480 | 481 |
| | Total | 107 | 488 | 595 |
| Positive Percent Agreement (PPA) (sensitivity) | | 99.1% (94.4%, 99.8%) | | |
| Negative Percent Agreement (NPA) | | 98.4% (96.8%, 99.2%) | | |

ANALYTICAL PERFORMANCE

Detection Limit

The Limits of Detection (LoD) for the CRP and MxA assays on the FebriDx test were determined on two (2) lots of tests with two (2) operators. A series of whole blood samples spiked with MxA and CRP analytes at concentrations spanning the assay range were blinded to test operators, tested, and read to determine the Limit of Detection (LoD) concentration (C95) and the C5. Based on the study results, the LoD was conservatively established as 40 ng/ml for the MxA assay and 20 ug/mL for the CRP assay.

Precision and Reproducibility Study

The Precision & Reproducibility study was run at three (3) sites over five (5) days with two (2) medical professionals at each site who were representative of intended users, three (3) test kit lots and eighteen (18) blinded samples per run consisting of 3 blinded replicates of each sample. The evaluated panel members included C5 and C95 concentrations of both MxA and CRP as described below.

| Sample | Sample Description |
|--------|------------------------------|
| P1 | C5 CRP/C95 MxA |
| P2 | C95 CRP/C5 MxA |
| P3 | C95 CRP/C95 MxA |
| P4 | C95 CRP/high (120 ng/mL) MxA |
| P5 | High (150 ug/mL) CRP/C95 MxA |
| P6 | Negative (0 CRP/0 MxA) |

The results demonstrate that the test is reproducible across the expected range of variability that would be encountered during normal expected use in the intended use setting.

Reproducibility Study Results Final Interpretation – By Site

| Sample | % Agreement with Expected Results | | | | |
|--------|-----------------------------------|--------------|---------------|---------------|------------|
| | Site 1 | Site 2 | Site 3 | Overall | 95% CI |
| P1 | 80% (24/30) | 70% (21/30) | 76.7% (23/30) | 75.6% (68/90) | 65.8-83.3% |
| P2 | 100% (30/30) | 90% (27/30) | 73.3% (22/30) | 87.8% (79/90) | 79.4-93.0% |
| P3 | 100% (30/30) | 90% (27/30) | 100% (30/30) | 96.7% (87/90) | 90.7-98.9% |
| P4 | 100% (30/30) | 100% (30/30) | 100% (30/30) | 100% (90/90) | 95.9-100% |
| P5 | 100% (30/30) | 90% (27/30) | 93.3% (28/30) | 94.4% (85/90) | 87.7-97.6% |
| P6 | 100% (30/30) | 90% (27/30) | 100% (30/30) | 96.7% (87/90) | 90.7-98.9% |

Reproducibility Study Results Final Interpretation – By Lot

| Sample | % Agreement with Expected Results | | |
|--------|-----------------------------------|---------------|---------------|
| | Lot 1 | Lot 2 | Lot 3 |
| P1 | 75% (27/36) | 80.5% (29/36) | 66.7% (12/18) |
| P2 | 83.3% (30/36) | 91.7% (33/36) | 88.9% (16/18) |
| P3 | 100% (36/36) | 100% (36/36) | 83.3% (15/18) |
| P4 | 100% (36/36) | 100% (36/36) | 100% (18/18) |
| P5 | 91.7% (33/36) | 94.4% (34/36) | 100% (18/18) |
| P6 | 100% (36/36) | 100% (36/36) | 83.3% (15/18) |

Interfering Substances

The analytical specificity of the FebriDx test was determined by evaluating a series of samples that included MxA and CRP at the C95 concentration and negative levels in whole blood, spiked with interfering substances. The following substances were evaluated and found to not interfere at the listed concentrations:

| Test Substance | Concentration |
|----------------------|---------------|
| Acetaminophen | 15.6 mg/dL |
| Acetylsalicylic acid | 3 mg/dL |
| Alcohol | 789 mg/dL |
| Azithromycin | 1.11 mg/dL |
| Biotin | 3500 ng/mL |
| Caffeine | 10 mg/dL |
| Celecoxib | 0.879 mg/dL |
| Cetirizine HCl | 0.435 mg/dL |
| Conjugated Bilirubin | 40 mg/dL |

| | |
|------------------------|-------------|
| Dextromethorphan | 1.56 ug/dL |
| Doxycycline | 1.8 mg/dL |
| Furosemide | 1.59 mg/dL |
| HAMA | 524.6 ng/mL |
| Hemoglobin | 1000 mg/dL |
| Ibuprofen | 21.9 mg/dL |
| Imipenem | 18 mg/dL |
| Levofloxacin | 3.6 mg/dL |
| Loratadine | 0.5 mg/dL |
| Nicotine | 0.097 mg/dL |
| Oxymetazoline HCl | 0.09 mg/dL |
| Phenylephrine | 0.003 mg/dL |
| Prednisolone | 0.120 mg/dL |
| Protein (total) | 9 g/dL |
| Rheumatoid Factor (RF) | 50 IU/mL * |
| Salmeterol | 6.03 ug/dL |
| Tiotropium | 4.80 ng/dL |
| Triglycerides | 1500 mg/dL |
| Unconjugated Bilirubin | 40 mg/dL |
| Vancomycin | 12 mg/dL |

* Rheumatoid Factor levels of up to 1000 IU/mL were evaluated and false negative/false positive results were identified. The interference effect disappeared at concentrations less than or equal to 50 IU/mL.

Hook Effect

The Hook Effect study assessed whether a hook effect exists on either the CRP and/or the MxA assays on the FebriDx test. MxA and CRP analytes were spiked into blood at the high concentrations shown in the table below and tested in replicates of ten (10) for each sample. The results indicate that there is no hook effect in the FebriDx test for the CRP assay up to a concentration of 1000 ug/mL and for the MxA assay up to a concentration of 700 ng/mL.

Matrix Equivalency

Due to difficulties obtaining sufficient volumes of capillary blood, analytical studies for the FebriDx test were conducted with venous whole blood. To demonstrate equivalent analytical performance between venous whole blood and capillary fingerstick blood, a matrix equivalency study was conducted and similar LoDs for MxA and CRP were established for both matrices.

Venous and fingerstick blood samples procured from patients with a recent clinical fever were run on the FebriDx test and a reference ELISA method. Results of the comparisons for both MxA and CRP proteins showed agreement between the two sample matrices. This data is not intended to support a venous blood sample type.

TECHNICAL SUPPORT

Please contact Lumos Diagnostics Technical Support at +1 855-LumosDx or email technical.support@lumosdiagnostics.com for assistance.

GENERAL INQUIRIES

Please contact Phase Scientific Customer Support at +1 877-625-1603 or email care@indicaidusa.com for assistance.

REFERENCES

1. Harris AM, Hicks LA, Qaseem A. Appropriate antibiotic use for acute respiratory tract infection in adults: advice for high-value care from the American College of Physicians and the Centers for Disease Control and Prevention. *Ann Intern Med.* 2016;164(6):425-34.
2. Renati S, Linder J. Necessity of office visits for acute respiratory infections in primary care. *Fam Pract.* 2016;33(3):312-17.
3. https://www.cdc.gov/nchs/data/ahcd/namcs_summary/2018-namcs-web-tables-508.pdf.
4. Jansen KU, Knirsch C, Anderson AS. The role of vaccines in preventing bacterial antimicrobial resistance. *Nat Med.* 2018 Jan 9;24(1):10-19.
5. Shapiro NI, Self WH, Rosen J, et al. A prospective, multi-centre US clinical trial to determine accuracy of FebriDx point-of-care testing for acute upper respiratory infections with and without a confirmed fever. *Ann Med.* 2018;50(5):420-9.
6. Ronni T, Melen K, Malygin A, Julkunen I. Control of IFN-inducible MxA gene expression in human cells. *J Immunol.* 1993;150:1715-26.
7. Engelmann I, Dubos F, Lobert PE, et al. Diagnosis of viral infections using myxovirus resistance A (MxA). *Pediatrics.* 2015;135:e985-93.
8. Haller O, Kochs G. Human MxA protein: an interferon-induced dynamin-like GTPase with broad antiviral activity. *J Interferon Cytokine Res.* 2011;31(1):79-87.
9. Chieux V, Hober D, Chehadeh W, et al. MxA protein in capillary blood of children with viral infections. *J Med Virol.* 1999;59(4):547-51.
10. Chieux V, Hober D, Harvey J, et al. The MxA protein levels in whole blood lysates of patients with various viral infections. *J Virol Methods.* 1998;70(2):183-191.
11. Falk G, Fahey T. C-reactive protein and community-acquired pneumonia in ambulatory care: systematic review of diagnostic accuracy studies. *Fam Pract.* 2009;26(1):10-21.
12. Bray C, Bell LN, Liang H, et al. Erythrocyte Sedimentation Rate and C-reactive Protein Measurements and Their Relevance in Clinical Medicine. *WMJ.* 2016;115(6):317-21.

13. Hatherill M, Tibby SM, Sykes K, et al. Diagnostic markers of infection: comparison of procalcitonin with C-reactive protein and leucocyte count. *Arch Dis Child.* 1999;81:417-21.
14. Andreola G, Bressan S, Callegaro S. Procalcitonin and C-reactive protein as diagnostic markers of severe bacterial infections in febrile infants and children in the emergency department. *Pediatr Infect Dis J.* 2007;26(8):672-7.
15. Korppi M, Kroger L. C-reactive protein viral and bacterial respiratory infection in children. *Scand J Infect Dis.* 1993;25(2):207-13.
16. Self WH, Rosen J, Sharp SC, et al. Diagnostic accuracy of FebriDx: a rapid test to detect immune responses to viral and bacterial upper respiratory infections. *J Clin Med.* 2017;6:E94.

SYMBOLS



Caution



Number of tests



Temperature limit



Do not use if package is opened or damaged



Do not re-use



in vitro diagnostics



Expiration date



Catalogue number



Date of manufacture



Batch code



Consult instructions for use



Manufacturer

ORDERING AND CONTACT INFORMATION

Telephone: 657-233-5880 (9:00a.m. to 5:00p.m. CST M-F)

In partnership with Lumos Diagnostics Inc.

PHASESCIENTIFIC



Distributed by PHASE Diagnostics, Inc.

10527 Garden Grove Blvd., Garden Grove, CA 92843 USA
www.phasescientificamericas.com

Lumos Diagnostics, Inc.

2724 Loker Avenue West, Carlsbad, CA 92010 USA
www.lumosdiagnostics.com

PM-548.0 MAR 2026
DR-L024-02(01)